

#266/#203 ELECTRIC CAN OPENER

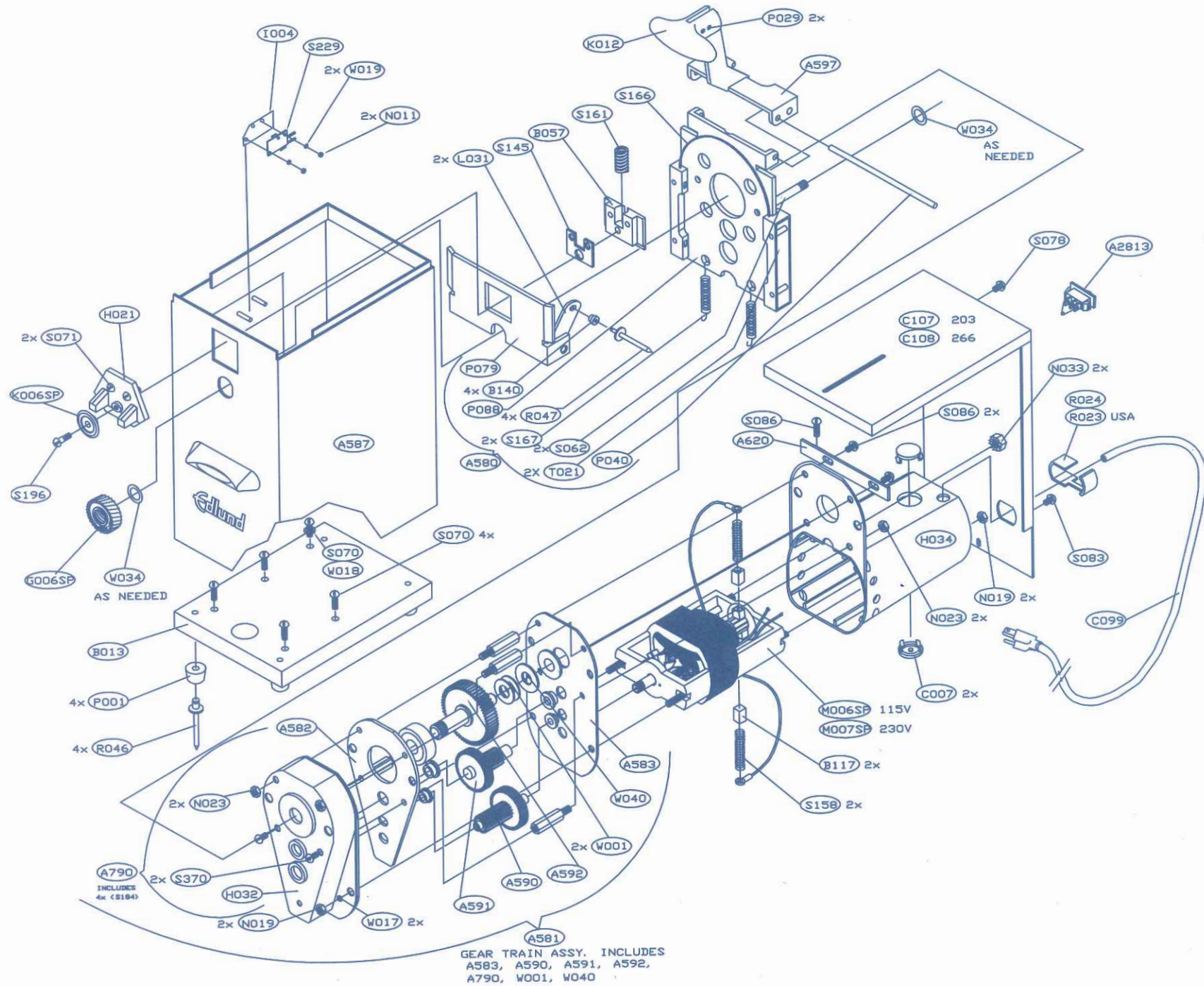

**#266/#203 ELECTRIC CAN OPENER**

| <b>PART #</b> | <b>PRICE</b> | <b>U/M</b> | <b>DESCRIPTION</b>                           |
|---------------|--------------|------------|--|
| A2813         | \$19.00      | EA.        | ASSEMBLY, #203/#270 ROCKER SWITCH 115V/230V  |
| A580          | \$52.00      | EA.        | ASSEMBLY, #203/#266 LINKAGE                  |
| A581          | \$134.00     | EA.        | ASSEMBLY, #266 GEAR TRAIN                    |
| A582          | \$24.50      | EA.        | ASSEMBLY, #203/#266 FRONT GEAR PLATE         |
| A583          | \$9.50       | EA.        | ASSEMBLY, 203/#266 REAR GEAR PLATE           |
| A587          | \$115.50     | EA.        | ASSEMBLY, #203/#266 CHANNEL                  |
| A588          | \$461.00     | EA.        | ASSEMBLY, #203/#266 MOTOR & GR. TN. 115V     |
| A589          | \$22.50      | EA.        | ASSEMBLY, #203 SWITCH                        |
| A590          | \$15.00      | EA.        | ASSEMBLY, #203/#266 FIRST PINION             |
| A591          | \$21.00      | EA.        | ASSEMBLY, #203/#266 SECOND PINION            |
| A592          | \$30.00      | EA.        | ASSEMBLY, #203/#266 OUTPUT SHAFT             |
| A593          | \$462.00     | EA.        | ASSEMBLY, #203/#266 MOTOR & GR. TN. 230V     |
| A597          | \$9.00       | EA.        | WELDMENT, #203/#266 TRUNION                  |
| A620          | \$5.80       | EA.        | ASSEMBLY, #266 SWITCH BRACKET                |
| A790          | \$51.50      | EA.        | ASSEMBLY, #203/#266 FRONT HOUSING            |
| A950          | \$6.40       | EA.        | ASSEMBLY, #203/#266 SLD TRK BRKT W/SCREWS    |
| B013          | \$58.50      | EA.        | BASE, #203/#266                              |
| B028          | \$16.00      | EA.        | BEARING, BALL #203/#266                      |
| B031          | \$1.95       | EA.        | BEARING, #203/#266 BRONZE                    |
| B032          | \$1.30       | EA.        | BEARING, 1ST, #201/#266/#203                 |
| B040          | \$1.30       | EA.        | BEARING, 2ND, #201/#266/#203                 |
| B057          | \$16.00      | EA.        | BLOCK, #203/#266 SPRING                      |
| B116          | \$55.25      | EA.        | BREAKER, CANADIAN CIRCUIT                    |
| B117          | \$3.95       | EA.        | BRUSH, MOTOR (2 REQ)                         |
| B140          | \$3.85       | EA.        | BUSHING, ECO LINK                            |
| C007          | \$2.60       | EA.        | CAP, #203/#266/#270 BRUSH                    |
| C086          | \$102.50     | EA.        | COIL FOR MOTOR REPAIRS, 115V, #201/#266/#203 |
| C087          | \$95.00      | EA.        | COIL FOR MOTOR REPAIRS, 230V, #201/#266/#203 |
| C091          | \$0.60       | EA.        | CONNECTOR, #201/#203/#266/#270 LEAD S-11     |
| C098          | \$24.50      | EA.        | CORD, GOV'T SET, 9-1/2", SJT, 18/3 105       |
| C099          | \$13.50      | EA.        | CORD SET, REGULAR 7", 18/3, GRAY             |
| C107          | \$31.80      | EA.        | COVER, #203                                  |
| C107M         | \$31.80      | EA.        | WELDMENT, #203 COVER CSA                     |
| C108          | \$31.80      | EA.        | COVER, #266                                  |
| C108M         | \$31.80      | EA.        | WELDMENT, #266 COVER CSA                     |
| E026          | \$0.60       | EA.        | EDGE, #203 SWITCH PROTECTOR                  |
| G006M         | \$158.00     | BOX        | GEAR, #201/#266/#203 24 PKG.                 |
| G006SP        | \$7.05       | PKG.       | GEAR, #201/#266/#203 SINGLE PACK             |
| H021          | \$23.00      | EA.        | HOLDER, #201/#266/#203 KNIFE                 |
| H032          | \$12.25      | EA.        | HOUSING, #203/#266 FRONT                     |
| H034          | \$17.75      | EA.        | HOUSING, #203/#266 REAR                      |
| I004          | \$10.50      | EA.        | INSULATOR, MICRO SWITCH PAD                  |
| K006M         | \$158.00     | BOX        | KNIFE, #201/#266/#203 24 PKG.                |
| K006SP        | \$7.05       | PKG.       | KNIFE, #201/#266/#203 SINGLE PACK            |
| K010          | \$7.75       | EA.        | KNIFE, #266 OVERSIZE                         |
| K012          | \$29.00      | EA.        | KNOB, #201/#266/#203                         |
| L031          | \$1.30       | EA.        | LINK, #203/#266                              |

*Continued on page 20*

## #266/#203 ELECTRIC CAN OPENER

Continued from page 19

| PART #  | PRICE    | U/M  | DESCRIPTION                                    |
|---------|----------|------|--|
| M006SP  | \$256.50 | EA.  | MOTOR, #203/#266 115V                          |
| M007SP  | \$279.00 | EA.  | MOTOR, #203/#266 230V, B-8992                  |
| N011    | \$0.60   | EA.  | NUT, 4-40 BRASS                                |
| N015    | \$4.50   | EA.  | NUT, 8-32, CLINCH #SN82NC27                    |
| N019    | \$0.60   | EA.  | NUT, 10-32 PLATED HEX                          |
| N023    | \$0.60   | EA.  | NUT, 8-32 PLATED HEX                           |
| N033    | \$0.60   | EA.  | NUT, 1/4-28 THD. SHAKEPROOF (KEPS)             |
| P001-4  | \$5.00   | EA.  | PAD, #266/#203/#395 FOOT, 4 PACK               |
| P029    | \$0.60   | EA.  | PIN, ROLL 1/8 X 9/16 S/S                       |
| P040    | \$1.50   | EA.  | PIN, #203/#266 TOGGLE                          |
| P079    | \$5.50   | EA.  | PLATE, #203/#266 KNIFE SLIDE                   |
| P088    | \$17.85  | EA.  | PLATE, #203/#266 MOTOR SLIDE                   |
| R023    | \$1.30   | EA.  | RELIEF, ELECTRIC STRAIN                        |
| R024    | \$1.30   | EA.  | RELIEF, STRAIN, ENGLISH ELECT., SMALL          |
| RO46    | \$0.60   | EA.  | RIVET, SB 5-6                                  |
| RO47    | \$1.30   | EA.  | RIVET, SB 6-6                                  |
| S062    | \$3.25   | EA.  | SCREW, #203/#266 HOUSING                       |
| S070    | \$0.60   | EA.  | SCREW, 10-32 X 5/16 PLATED RHM                 |
| S071-12 | \$7.20   | PKG. | SCREW, 10-32 X 7/16 RHM, PLATED, 12 PACK       |
| S078    | \$0.60   | EA.  | SCREW, 6-32 X 1/4 S/S RHM                      |
| S083    | \$0.60   | EA.  | SCREW, 8-32 X 3/16 S/S RHM                     |
| S086    | \$0.60   | EA.  | SCREW, 8-32 X 5/8 S/S PLATED RHM               |
| S145    | \$0.60   | EA.  | SPACER, #201/#266/#203 KNIFEHOLDER             |
| S158    | \$2.60   | EA.  | SPRING, #201/#266/#203/#270/#350 BRUSH (2 REQ) |
| S161    | \$2.60   | EA.  | SPRING, #201/#266/#203 BLOCK                   |
| S166    | \$2.25   | EA.  | SPRING, #203/#266 RETURN                       |
| S167    | \$1.30   | EA.  | SPRING, ECO TENSION                            |
| S184    | \$3.00   | EA.  | STANDOFF, #203/#266 LONG                       |
| S196    | \$5.30   | EA.  | STUD, #201/#266/#203 KNIFE                     |
| S229    | \$11.75  | EA.  | SWITCH, #203/#266 LEAF                         |
| S235    | \$14.00  | EA.  | SWITCH, PREVIOUS #203 TOGGLE, 7503K13          |
| S370    | \$0.60   | EA.  | SCREW, 8-32 X 1/2 RHM PLATED                   |
| T006    | \$1.95   | EA.  | TERMINAL, #203/#266 FEMALE, 3/16               |
| T007    | \$1.30   | EA.  | TERMINAL, ROUND                                |
| T021    | \$9.50   | EA.  | TRACK, #203/#266 SLIDE                         |
| W001    | \$1.30   | EA.  | WASHER, #203/#266 BELLVILLE SPRING             |
| W017    | \$0.60   | EA.  | WASHER, #10 EXT. TOOTH LOCK, PTD               |
| W018    | \$0.60   | EA.  | WASHER, #10 X 3/16 PLATED LOCK                 |
| W019    | \$0.60   | EA.  | WASHER, #4 INTRL. TOOTH LOCK, S/S              |
| W034    | \$0.60   | EA.  | WASHER, ECO DRIVE GEAR SPACER                  |
| W040    | \$0.60   | EA.  | WASHER, #203/#266 THURST                       |
| W055    | \$0.60   | FT   | WIRE, 18 GA. BLACK (ELECTRIC JUMPER)           |

For all service,  
warranty or spare  
parts requirements,  
please call  
**03 9368 2300**