



DCS400-1-BN



DCSB400-2420-1-NSBN



DCSB400-3624-2-GGBN

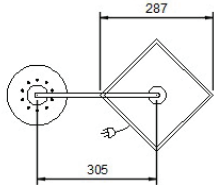

TOP VIEW

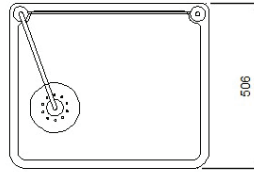

TOP VIEW

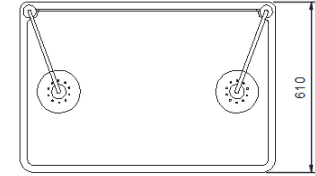

TOP VIEW

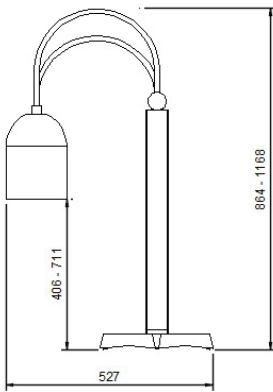

SIDE VIEW

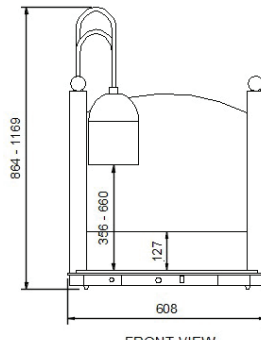

FRONT VIEW
NTS

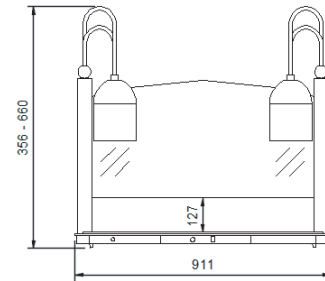

FRONT VIEW
NTS

Providing proper food serving temperatures, the **Decorative Carving Station** combines the **Hatco Decorative Heat Lamp** with the Swanstone® Heated Base to create an attractive carving display. These warmers are perfect for chef stations in restaurants, hotels, country clubs, casinos and catered events.

STANDARD FEATURES

- Available as Post Mount, Counter Mount or Freestanding with a round or rectangular heated stone base
- Patented telescoping adjustable post pivots 30° to put the heat and light where it is needed
- Height can be adjusted from from the bottom of lamp to top of the cutting board.

SPECIFICATIONS

Model	Dimension (WxDxH)	Weight	Supplied Coreded	Watts	Amps
DCS400-1-BN	203 x 527 x 864-1168 mm	15kg	10 amp plug	250	1
DCSB400-2420-1-NSBN	608 x 506 x 864-1168 mm	48kg	10 amp plug	750	3.2
DCSB400-3624-2-GGBN	911 x 610 x 864-1168 mm	70kg	10 amp plug	1300	5.5