

ACQUA

New Generation Tapware

Replacement Parts shown in Red

AQW3180CB, AQW330CB Wall Mount Faucets

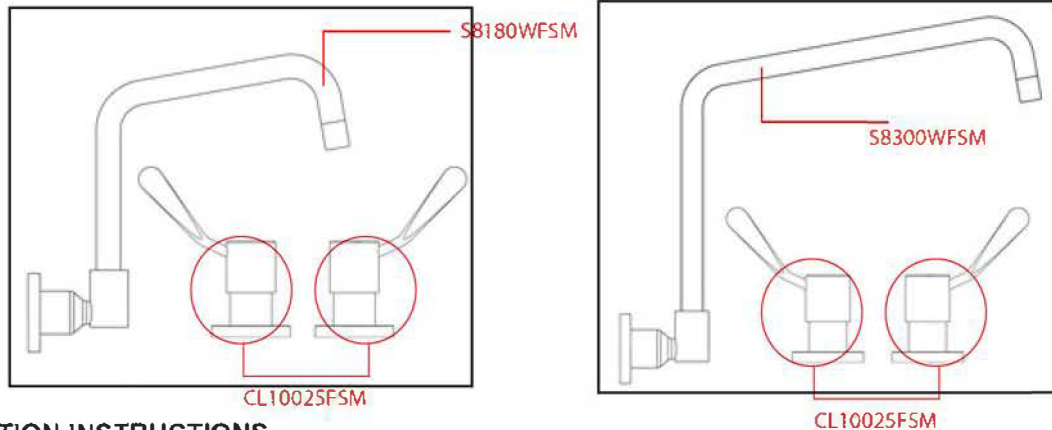

INSTALLATION INSTRUCTIONS

1. Remove plastic protective cap, locknut, red fibre washer and adjustable chrome cover from SBA cartridge.
2. Insert SBA cartridge into wall body and tighten until it comes to a firm stop.
3. Replace the red fibre washer and the locknut. Tighten the locknut firmly
4. Place flange over SBA cartridge and screw the chrome cover onto to the spindle tightly so that the flange sits flat on the wall. The adjustable chrome cover can be used in either direction to suit the wall thickness
5. Place the handle over the spindle and then the washer and grub screw (supplied) and tighten until handle is firm and can be turned easily without wobbling.
6. Use the required coloured indicator (red, blue supplied) and fit over the grub screw until it sits flush on the handle.
7. To install spout, place flange over exposed breaching piece and screw spout on until firm.

CUTOUT DIMENSIONS BOTH MODELS - Spouts 22mm. Taps 22mm.

IMPORTANT NOTE:

We do not recommend dismantling the internal parts of the mixer. The mixers are individually factory assembled and tested to give the best performance.

GENERAL INFORMATION

Acqualine Products come with guarantees that cannot be excluded under the Australian Consumer Law. If the problem is deemed to be a product fault, product will be repaired or replaced at our discretion.

NOTE: Failure to comply with the following will void all warranty:

- During the warranty period, we will replace/repair the mixer free of charge. SEE DETAILS BELOW.
- The warranty is extended to the purchaser only and is not transferable.
- All mixers should be installed with isolating stop valves.
- Use only suitable agents to clean the surface of your mixer (ie mild detergent and cloth. No abrasive cleaners).
- The mixer must be installed by a licensed plumber.
- If the incoming water pressure exceeds 500KPa, an approved limiting valve must be fitted. All new connections must be flushed prior to the connection.
- Approved operating temperature is not to exceed 80°C
- Water Saving Devices maybe required.
- Minimum Operating Pressure 150KPa. Maximum Operating Pressure 350KPa.

STANDARD/ COMPLIANCES

Instal Acqualine tapware in confidence, all Acqualine products are tested to AS/NZS3718, AS4020 and AS/NZS6400 and comply with Australian regulations.